

Ambulance Service Directions

4 – 8 Charles Street comprises 111 apartments.

Apartment locations:

- **1 – 66** are in the **North Tower**. - towards **North Terrace**
- **67 – 111** are in the **South Tower**. - towards **Rundle Mall**
 - **Access is via basement car park – timed fastest approach**

The table below identifies:

- Apartment Number
- Floor Level Number of the apartment
- Page Numbers in this document where instructions tell you how to get to the apartment

North Tower		
Apartment No.	Level	Page No.
1 – 12	1	2 and 8
13 – 24	2	2 and 10
25 – 36	3	2 and 12
37 – 48	4	2 and 14
49	5	2 and 16
49 – 60	6A	2 and 17
61 – 66	7A	2 and 18

South Tower		
Apartment No.	Level	Page No.
67 – 75	1	2 and 23
76 – 84	2	2 and 25
85 – 93	3	2 and 26
94 – 102	4	2 and 27
103 – 111	5	2 and 28
Car Park (North Tower)		2 and 5

Access to the South Tower is also possible from Charles Street, see page 20. However, access via the basement car park is fastest, if you are unfamiliar with the building. On leaving a South Tower apartment, take the lift down to ground level and you will exit into the Charles Street mall. Turn left and take the ramp into Charles Street. Your ambulance will probably be on your right.

Note: Access to apartment 49 is possible from level 6A but the preferred level of entry is level 5.

If you need specific advice/assistance the following numbers may be of relevance.

Greg Powell, Building Caretaker: 0402 214 109

Phillip Relf, resident (apt 5): 0403 070 370

North Tower - Lifts

Present FOB key to enter lift foyer





You need to **take the lift on the left** for the stretcher to fit (it will not fit in the lift on the right).

Press **UP** button for the North Tower apartments
(1 – 66)

Press **DOWN** button for the car park and access to South Tower apartments
(67 – 111)

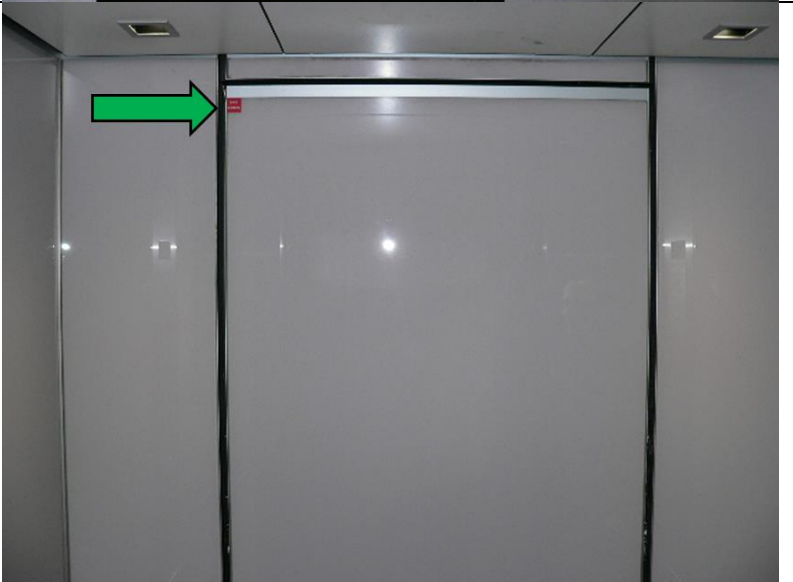

<p>Left Lift</p>	
<p>View inside left lift Note panel at back of lift</p>	
<p>This panel opens to give extra space for the stretcher</p>	

Present FOB to activate buttons

Press level number button for the apartments

1 - 12	Level 1
13 - 24	Level 2
25 - 36	Level 3
37 - 48	Level 4
49	Level 5
49 - 60	Level 6A
61 - 66	Level 7A

Press "B" button for the car park
– access to South Tower

NOTE: When the lift is talking it may not accept either the FOB presentation or the button press. Just re-swipe and press the button again



North Tower		
Apartment No.	Level	Page No.
1 – 12	1	Go To page 8
13 – 24	2	Go To page 10
25 – 36	3	Go To page 12
37 – 48	4	Go To page 14
49	5	Go To page 16
49 – 60	6A	Go To page 17
61 – 66	7A	Go To page 18

Note: Access to apartment 49 is possible from level 6A but the preferred level of entry is level 5.

South Tower access, continue on into basement, see next page.

Car Park - Basement in North Tower

Turn Left out of lift

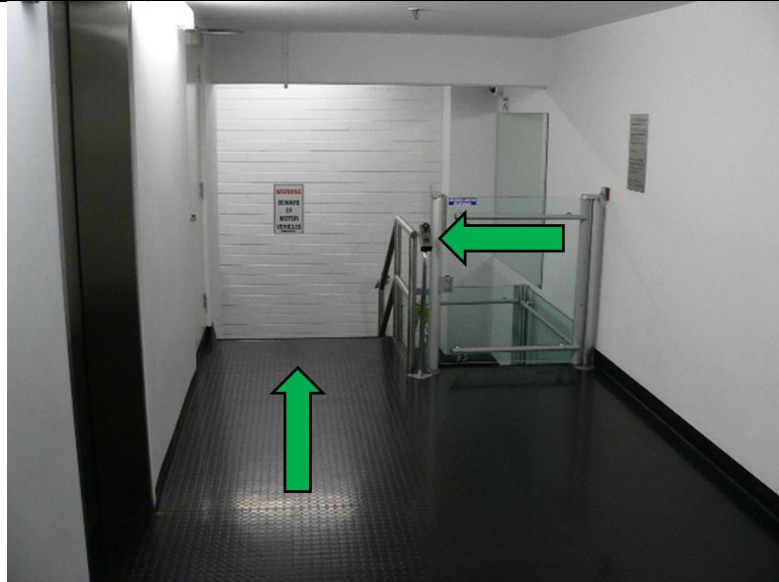

There is a mini lift for wheelchair access but it is very slow to operate

– just hold the button down (indicated by horizontal green arrow)

Down a couple of stairs and turn left



Down the short corridor
and turn Right



Access to South Tower lifts



You will see two lifts

The right one will operate
(there is no access to the
one on the left)



**Present FOB
(behind you)**

The lift will come when the
FOB is presented

The lift **WILL NOT COME**
on pressing the lift button

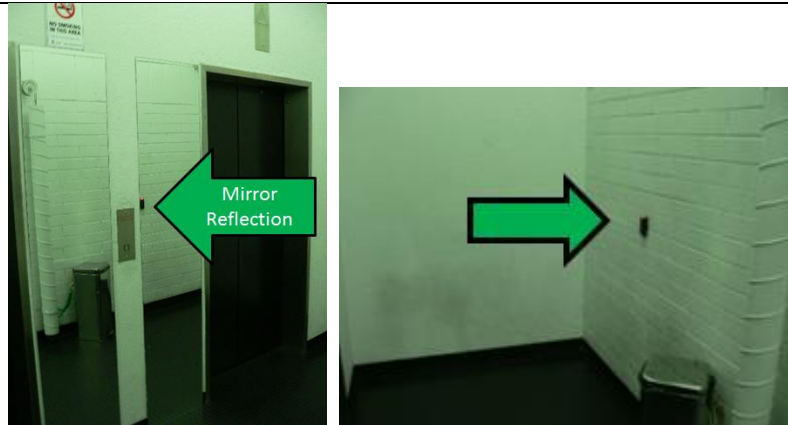

**Present FOB
AND then
Push floor button from
those on the RIGHT**

(the ones on the right get
you to the apartment
levels)

(the floor buttons on the
left get you to the car park
levels and not the
apartments)

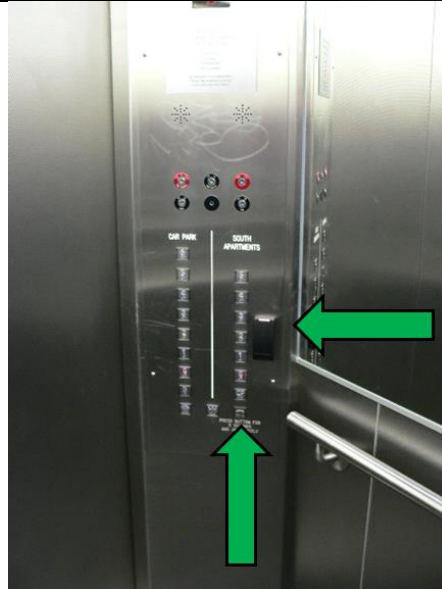

South Tower		
Apartment No.	Level	Page No.
67 – 75	1	Go To Page 23
76 – 84	2	Go To Page 25
85 – 93	3	Go To Page 26
94 – 102	4	Go To Page 27
103 – 111	5	Go To Page 28

North Tower - Level 1 (Apt. 1 – 12)

<p>Turn Right out of lift</p>	
<p>Present FOB</p> <p>Enter through door</p> <p>Turn Right</p>	

Down corridor

Apt 1 on left

Apt 2 – 12 down corridor

Relative Apartment Locations		Number of Steps
Left	Right	
01		5 steps
	12	10 steps
02	11	18 steps
	10	25 steps
03	09	34 steps
04	08	42 steps
	07	52 steps
05		56 steps
	06	58 steps



North Tower - Level 2 (Apt. 13 – 24)

Turn Left out of lift

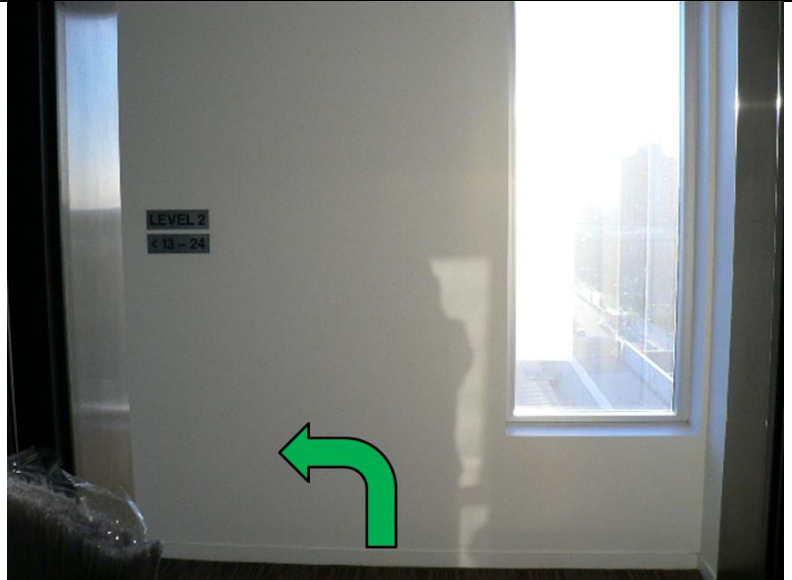

Turn Left



Turn Left

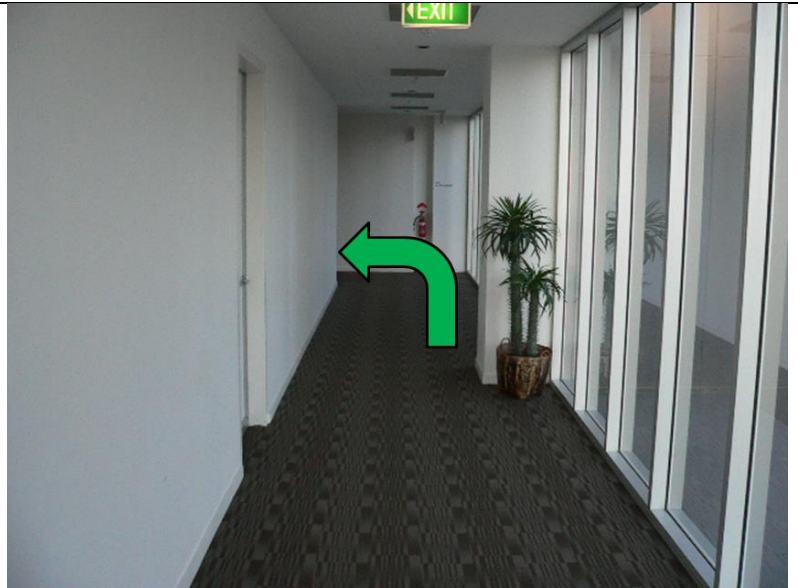

Apt 13
is to the left

Apts 14 – 24
are to the right
down the corridor



Relative Apartment Locations		Number of Steps
Left	Right	
13		
14		2 steps
	24	5 steps
	23	13 steps
15		17 steps
16		18 steps
	22	21 steps
	21	29 steps
17		33 steps
18		34 steps
19	20	47 steps



NOTE: Apartment 19 does not have a Door Number on the door. It is opposite apartment 20.

North Tower - Level 3 (Apt. 25 – 36)

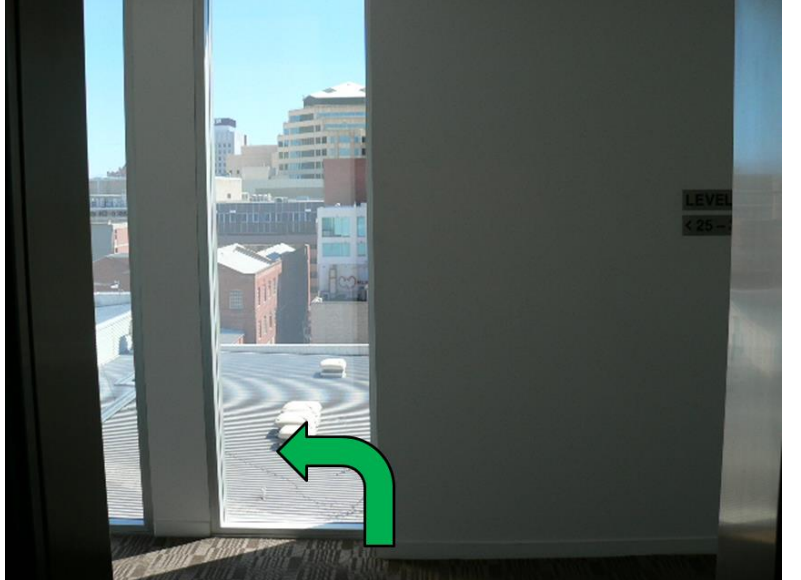
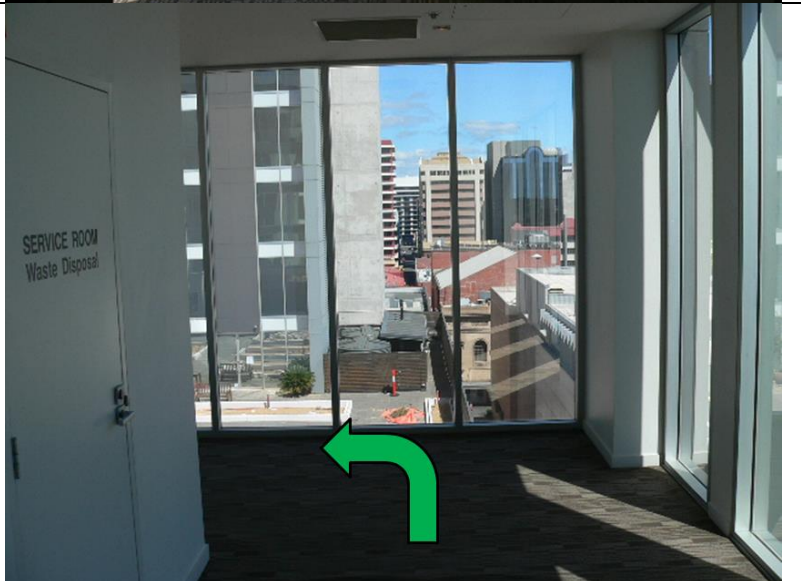
Turn Left out of lift	 A photograph taken from inside a lift on Level 3, looking out a large window. The view shows a city street with buildings and a clear blue sky. A green arrow is overlaid on the image, pointing left towards the window.
Turn Left	 A photograph taken from a hallway on Level 3, looking out a large window. The view shows a city street with buildings and a clear blue sky. A green arrow is overlaid on the image, pointing left towards the window. To the left of the window, a door is visible with the text "SERVICE ROOM Waste Disposal" on it.

Turn Left



Apt 25
is to the left

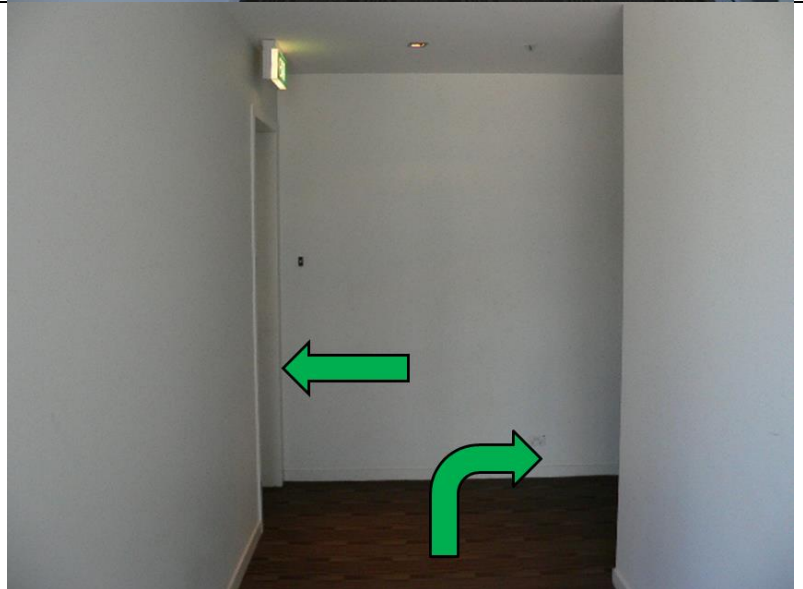

Apts 26 – 36
are to the right
down the corridor



Relative Apartment Locations		Number of Steps
Left	Right	
25		
26		2 steps
	36	6 steps
	35	15 steps
27		19 steps
28		20 steps
	34	24 steps
	33	33 steps
29		37 steps
30		38 steps
31	32	51 steps

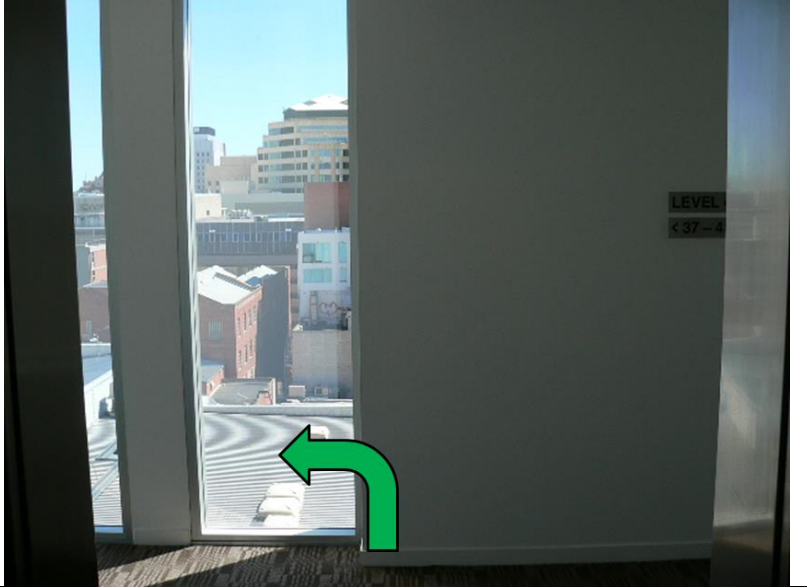

North Tower - Level 4 (Apt. 37 – 48)

<p>Turn Left out of lift</p>	 A photograph showing a view from inside a lift on Level 4. The lift is open, and a green arrow points left towards the window. Outside the window, a city skyline is visible under a clear blue sky. A sign on the right wall of the lift reads "LEVEL 4" and "37-48".
<p>Turn Left</p>	 A photograph showing a view from a hallway on Level 4. A green arrow points left towards a large window. Outside the window, a city skyline is visible under a clear blue sky. To the left of the window, a door is labeled "VICE ROOM" and "ite Disposal".

Turn Left



Apt 37
is to the left

Apts 38 – 48
are to the right
down the corridor

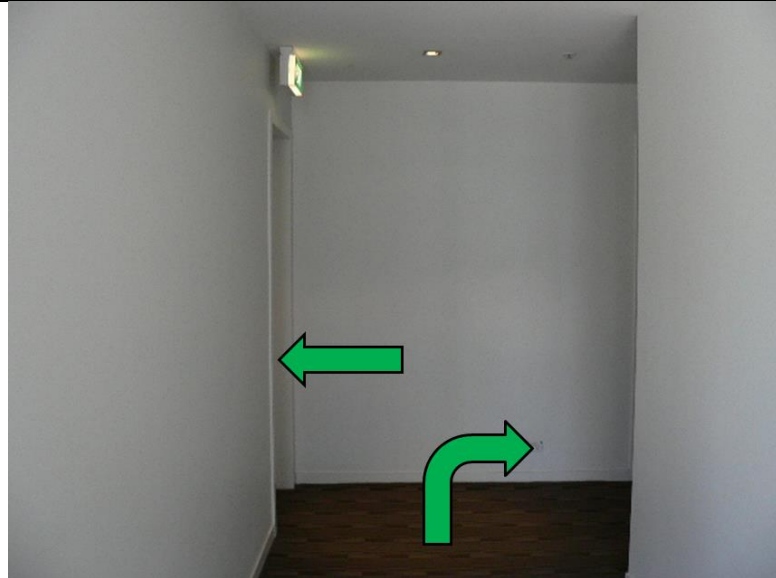

Relative Apartment Locations		Number of Steps
Left	Right	
37		
38		2 steps
	48	6 steps
	47	15 steps
39		19 steps
40		20 steps
	46	24 steps
	45	33 steps
41		37 steps
42		38 steps
43	44	51 steps



North Tower - Level 5 (Apt. 49)

Turn Right out of lift

You are in apartment 48
when you leave the lift



But the separation doors
may be closed.



North Tower - Level 6A (Apt. 49 – 60)

Turn Right out of the lift



Relative Apartment Locations		Number of Steps
Left	Right	
56		5 steps
	49	8 steps
57		19 steps
	50	22 steps
	51	24 steps
58		35 steps
	52	40 steps
	53	41 steps
59		45 steps
	54	56 steps
	55	58 steps
60		59 steps

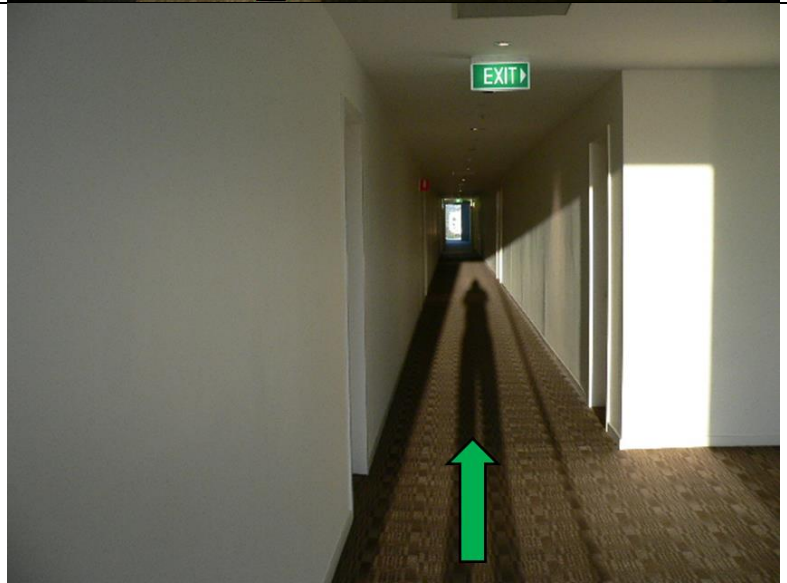

North Tower - Level 7A (Apt. 61 – 66)

Turn Left out of lift



Turn Left



Turn Left

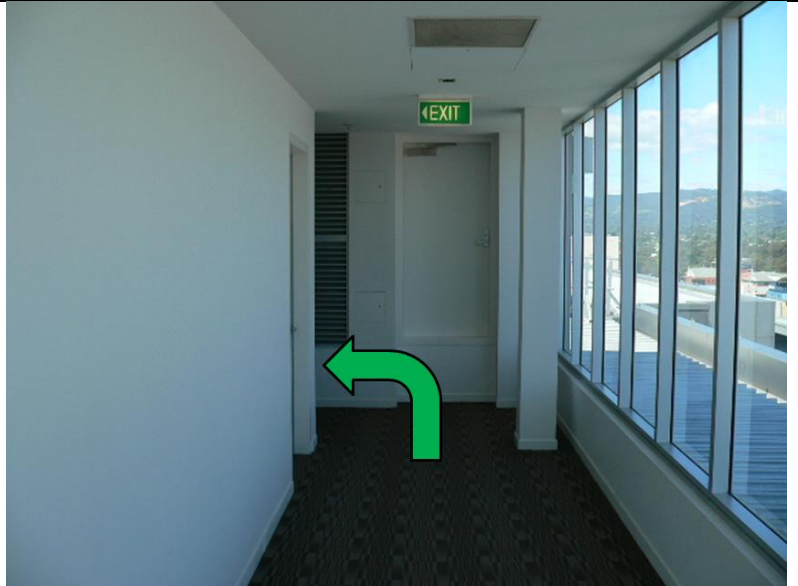

Apt 61
is straight ahead

Apts 62 – 66
are to the right
down the corridor





Relative Apartment Locations		Number of Steps
Left	Right	
61		
62		15 steps
63		17 steps
64		33 steps
65		35 steps
66		44 steps

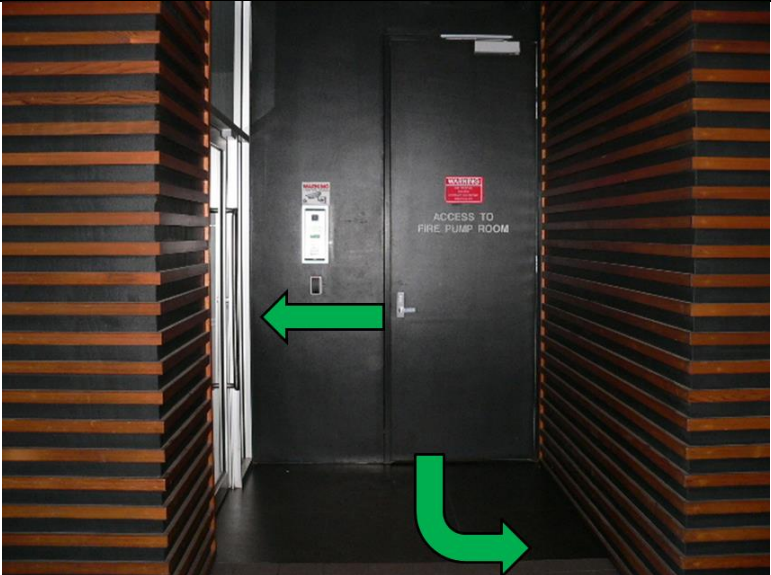
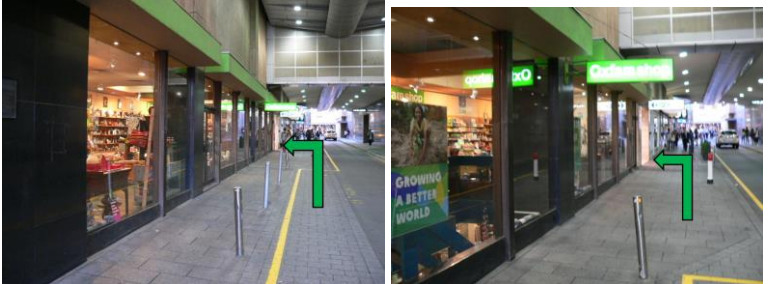

South Tower - Lifts

Note: Access to the South Tower apartment lift is available at ground level too but if you don't know where the South Tower lift is, it is much faster to take the North Tower lift to the basement, then walk to the South Tower lift and call the South Tower lift from the basement.

<p>Exit back to Charles Street</p> <p>Turn Left along Charles Street</p> <p>(Arrow pointing left indicates where you picked up this map)</p>	
<p>Past Oxfam and Turn Left</p>	
<p>After Hours ONLY The glass doors may be closed, you will need to present the FOB to open the door.</p> <p>If you need to, you can call the apartment on the intercom – enter the apartment number followed by the 'bell' symbol.</p>	

Turn Right



**Need to take the RIGHT
most lift ONLY**

But before you can call
the lift, you need to
present the FOB, see next
photograph.

**(Left and Middle lifts DO
NOT go to apartments)**

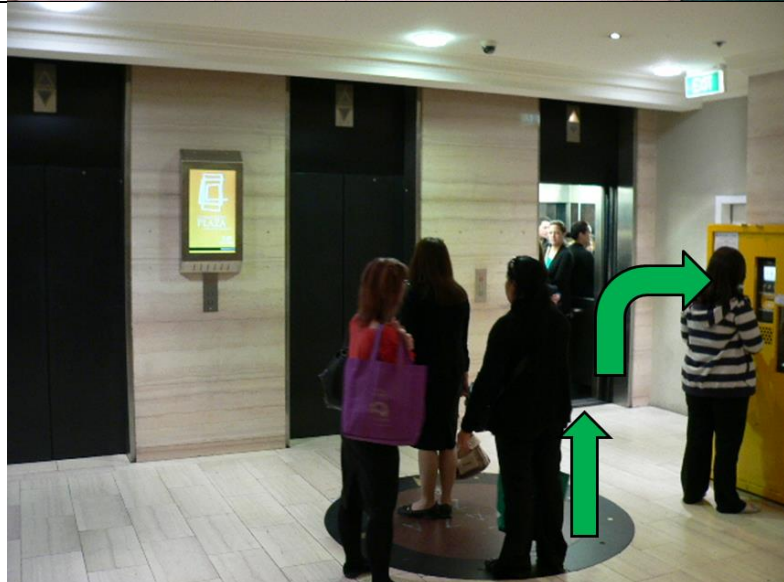

**Present FOB
AND then call lift**



Lift Open



**Present FOB
AND then
Push floor button from
those on the RIGHT**

**(the ones on the right get
you to the apartment
levels)**

**(the floor buttons on the
left get you to the car park
levels and not the
apartments)**

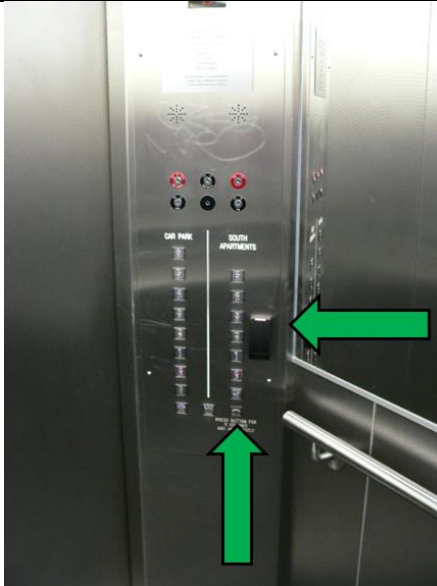

South Tower - Level 1 (Apt. 67 – 75)

Head straight out of lift



Turn Right



Present FOB to enter
corridor



Relative Apartment Locations		Number of Steps
Left	Right	
67	75	3 steps
68	74	12 steps
69	73	18 steps
70	72	27 steps
	71	35 steps



South Tower - Level 2 (Apt. 76 – 84)

Head straight out of lift

Turn Right



Relative Apartment Locations		Number of Steps
Left	Right	
76	84	10 steps
77	83	19 steps
78	82	26 steps
79	81	36 steps
	80	44 steps



South Tower - Level 3 (Apt. 85 – 93)

Head Straight out of lift

Turn Right



Relative Apartment Locations		Number of Steps
Left	Right	
85	93	10 steps
86	92	19 steps
87	91	27 steps
88	90	36 steps
	89	44 steps



South Tower - Level 4 (Apt. 94 – 102)

Head Straight out of lift

Turn Right



Relative Apartment Locations		Number of Steps
Left	Right	
94	102	10 steps
95	101	19 steps
96	100	26 steps
97	99	35 steps
	98	44 steps

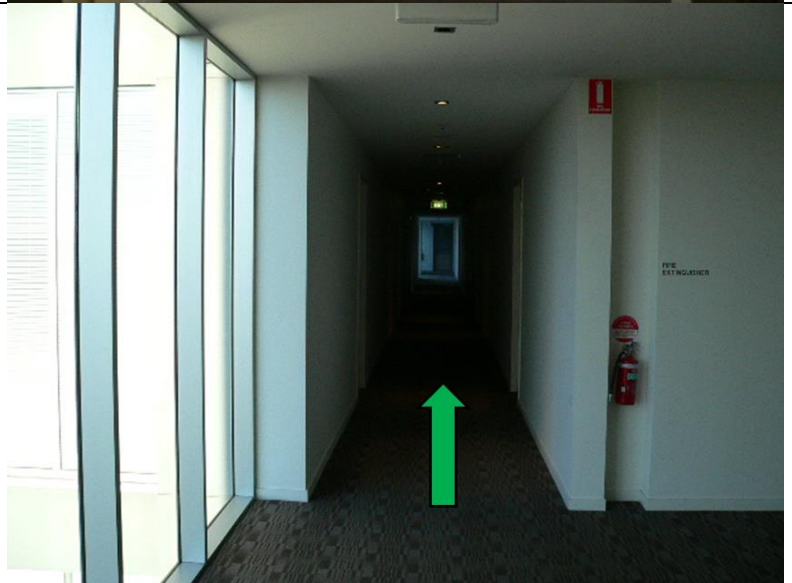

South Tower - Level 5 (Apt. 103 – 111)

Head Straight out of lift

Turn Right



Relative Apartment Locations		Number of Steps
Left	Right	
103	111	10 steps
104	110	19 steps
105	109	26 steps
106	108	35 steps
	107	43 steps

